



## NS1/L - CONDUIT NIPPLE

**Description** NS1/L - 20mm Conduit Screwed Nipple 300mm length

**Finish** BZP

**Material** Steel

**Packaging** Packed in qty 10

**Additional Notes** Compliant to LU Standard 1-085  
(For use on surface & sub-surface locations)

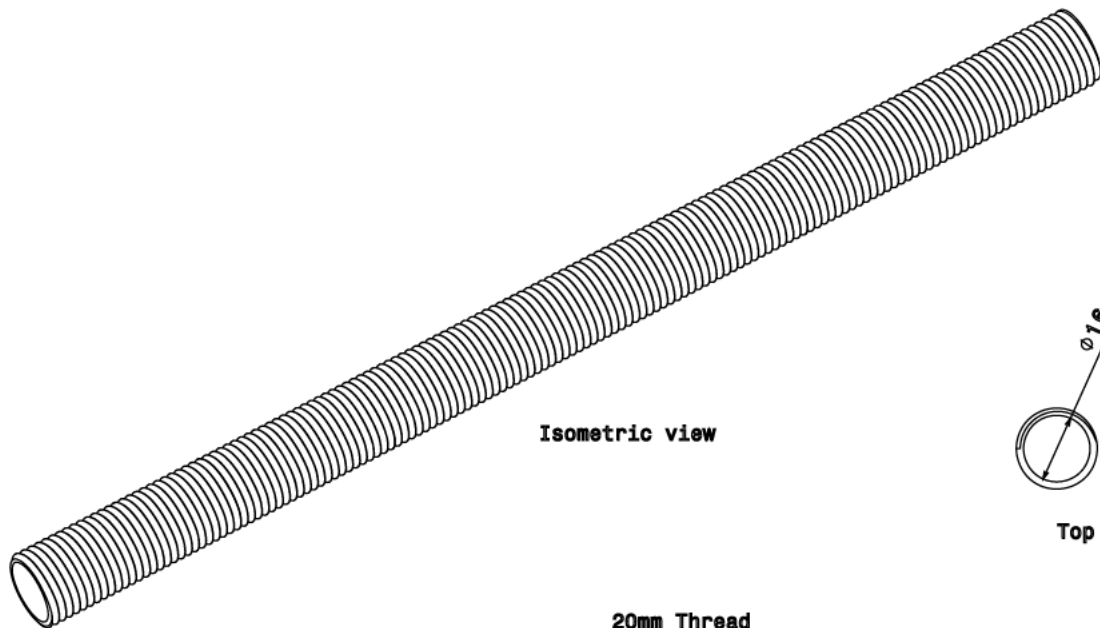

Isometric view

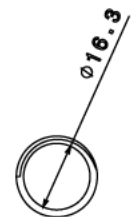

Top view

20mm Thread

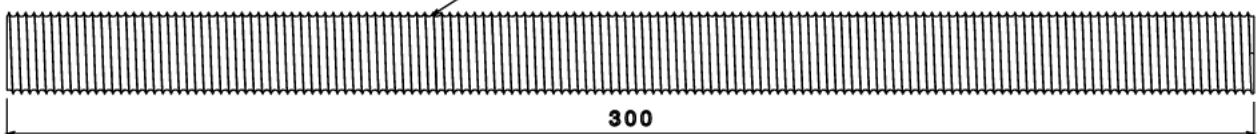

300

Side view

All measurements in mm unless otherwise stated